

£1,100 PCM

West Street, Fareham PO16 0EN

bernards
THE ESTATE AGENTS



HIGHLIGHTS

- ❖ TWO DOUBLE BEDROOMS
- ❖ WELL PRESENTED
- ❖ OPEN PLANNED LIVING
- ❖ NATURALLY DECORATED
- ❖ FURNISHED
- ❖ CENTRAL LOCATION
- ❖ MINUTES FROM TRANSPORT LINKS
- ❖ FIRST FLOOR
- ❖ A MUST VIEW
- AVAILABLE JANUARY

TWO BEDROOM APARTMENT

We are pleased to present this two bedroom apartment in the heart of Fareham.

The development lies within close proximity to Fareham town centre and transport links on to the M27.

The property consists of two

spacious double bedrooms and an open plan kitchen/lounge/diner which is the ideal space to entertain.

Completing the property is the modern fitted three piece bathroom, the ideal space to relax and unwind

We strongly recommend booking a viewing to avoid disappointment

Call today to arrange a viewing
01329756500
www.bernardsea.co.uk





Call today to arrange a viewing
01329756500
www.bernardsestates.co.uk



PROPERTY INFORMATION

KITCHEN/LOUNGE/DINER

22'3" x 10'1" (6.78m x 3.07m)

BEDROOM ONE

8'11" x 14'7" (2.72m x 4.45m)

BEDROOM TWO

11'11" x 8'11" (3.63m x 2.72m)

BATHROOM

9'1" x 5'8" (2.77m x 1.73m)

Right to Rent

Each applicant will be subject to the right to rent checks. This is a government requirement since February 2016. We are required to check and take a copy of the original version of acceptable documentation in order to adhere to the Right to rent checks. This will be carried out at referencing stage. Please speak to a member of staff for acceptable Identification.

Removal Quote

As part of our drive to assist clients with all aspects of the moving process, we have sourced a reputable removal company. Please ask a member of our sales team for further details and a quotation.



Energy Efficiency Rating		Current	Potential
Very energy efficient - lower running costs			
(92 plus) A			
(81-91) B			
(69-80) C			
(55-68) D		65	65
(39-54) E			
(21-38) F			
(1-20) G			
Not energy efficient - higher running costs			
England & Wales		EU Directive 2002/91/EC	



1ST FLOOR
566 sq.ft. (52.5 sq.m.) approx.

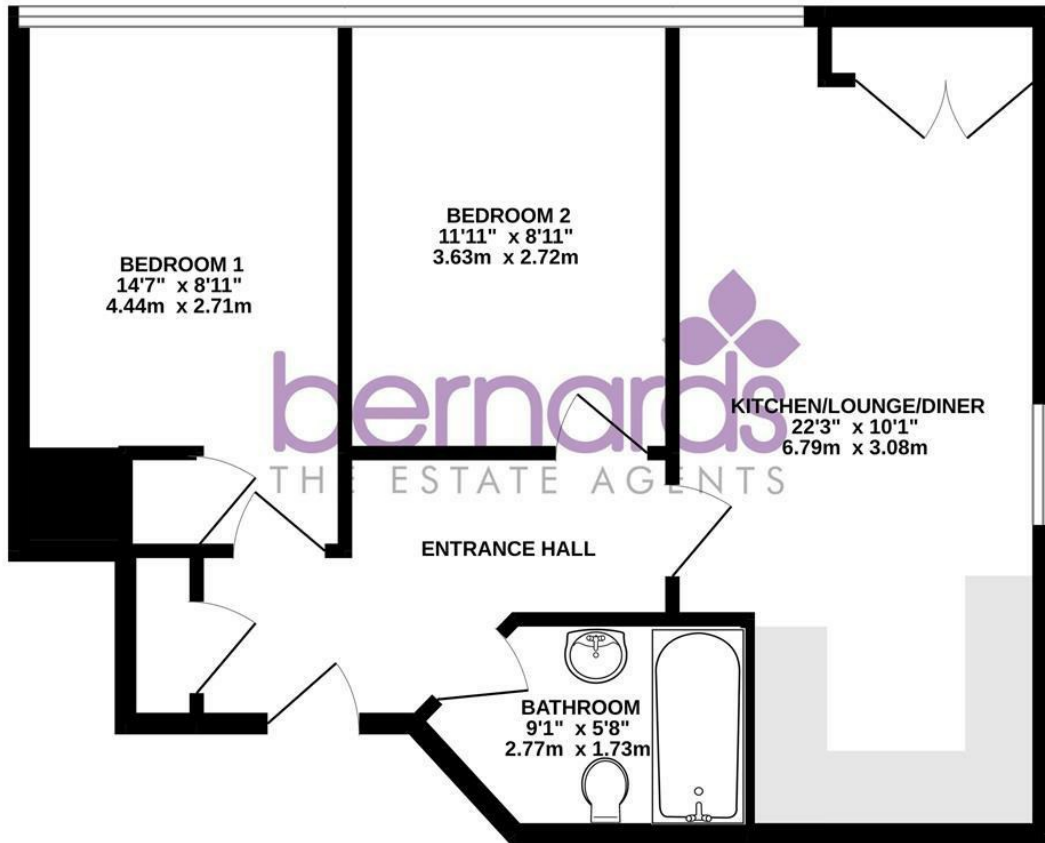

TOTAL FLOOR AREA : 566 sq.ft. (52.5 sq.m.) approx.

Whilst every attempt has been made to ensure the accuracy of the floorplan contained here, measurements of doors, windows, rooms and any other items are approximate and no responsibility is taken for any error, omission or mis-statement. This plan is for illustrative purposes only and should be used as such by any prospective purchaser. The services, systems and appliances shown have not been tested and no guarantee as to their operability or efficiency can be given.
Made with Metropix ©2022

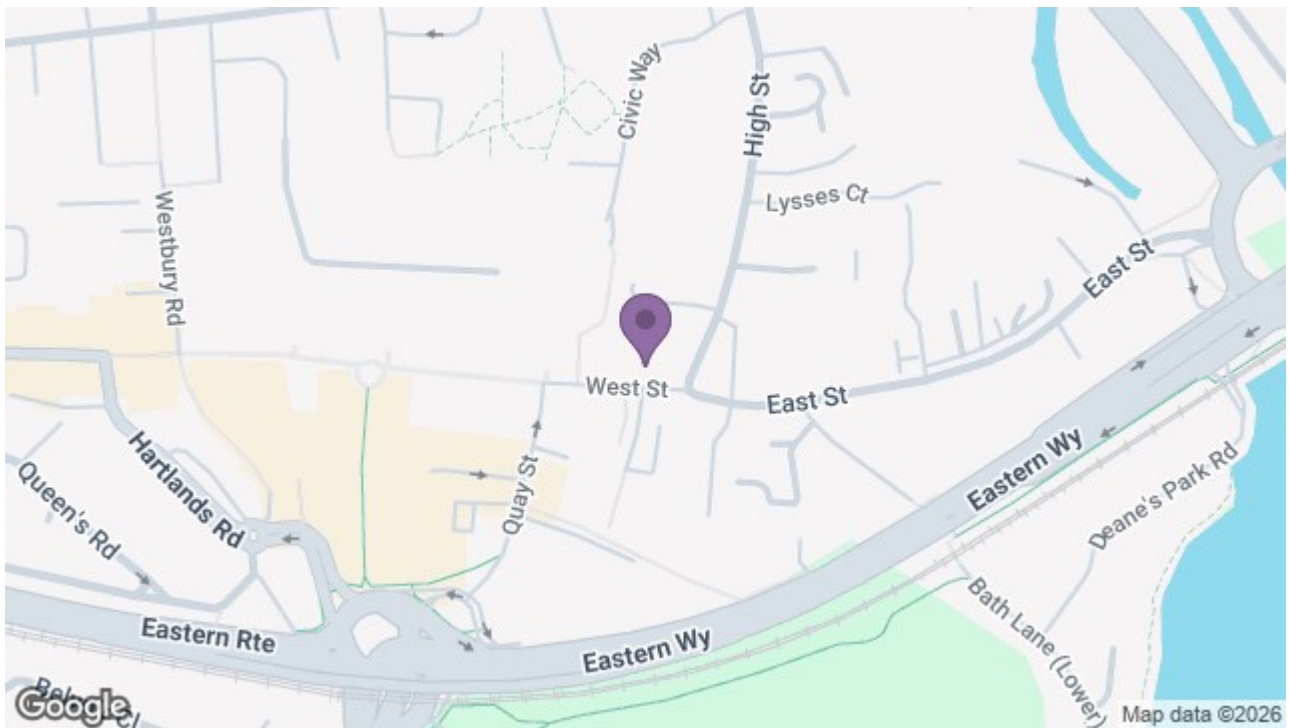

79 High Street, Fareham, Hampshire, PO16 7AX
t: 01329756500

